

# \$679,900 - 10706 150 Avenue, Rural Grande Prairie No. 1, County of

MLS® #A2192331

**\$679,900**

3 Bedroom, 3.00 Bathroom, 1,938 sqft  
Residential on 0.16 Acres

Whispering Ridge, Rural Grande Prairie No. 1,  
County of, Alberta

NOW OFFERING A \$10,000 Cash back incentive. The Meghan by Little Rock Builders is a 1900+ sq ft 2 story plan with a walk out basement, bonus room & upstairs laundry! This house is located in Whispering Ridge 10706 150 Ave. The main floor offers a functional open space that's great for hosting & entertaining. The kitchen, living and dining area is open, bright, super functional. It has a walk-through pantry that leads you into a boot room entry coming in from the garage. Plus there is a nice sized front entry. Upstairs you'll find 3 bedrooms, 2 full bathrooms, a bonus room & laundry room. The master bedroom includes a large wall in closet, beautiful ensuite and a large bedroom space. And you will appreciate the functional touches of the laundry room, double sinks in the main bath and the large bonus room. The oversized garage measures 36 X 25'6" giving you lots of space for vehicles & toys! Possession will be 3-4 months after we receive a conditional offer.

Built in 2025

## Essential Information

MLS® #	A2192331
Price	\$679,900
Bedrooms	3
Bathrooms	3.00

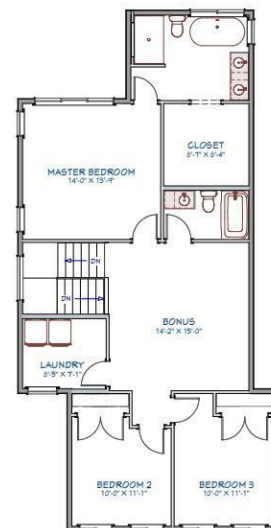

Full Baths	2
Half Baths	1
Square Footage	1,938
Acres	0.16
Year Built	2025
Type	Residential
Sub-Type	Detached
Style	2 Storey
Status	Active

### Community Information

Address	10706 150 Avenue
Subdivision	Whispering Ridge
City	Rural Grande Prairie No. 1, County of
County	Grande Prairie No. 1, County of
Province	Alberta
Postal Code	T8X 0S5

### Amenities

Parking Spaces	6
Parking	Triple Garage Attached
# of Garages	3

### Interior

Interior Features	See Remarks
Appliances	See Remarks
Heating	Forced Air
Cooling	None
Fireplace	Yes
# of Fireplaces	1
Fireplaces	Gas
Has Basement	Yes
Basement	Full, Unfinished

### Exterior

Exterior Features	Other
Lot Description	Back Yard, City Lot, Front Yard, Rectangular Lot, Standard Shaped Lot
Roof	Asphalt Shingle
Construction	See Remarks

Foundation                Poured Concrete

**Additional Information**

Date Listed                February 4th, 2025  
Days on Market            155  
Zoning                      RR-2

**Listing Details**

Listing Office              Grassroots Realty Group Ltd.

Data is supplied by Pillar 9â„¢ MLS® System. Pillar 9â„¢ is the owner of the copyright in its MLS® System. Data is deemed reliable but is not guaranteed accurate by Pillar 9â„¢. The trademarks MLS®, Multiple Listing Service® and the associated logos are owned by The Canadian Real Estate Association (CREA) and identify the quality of services provided by real estate professionals who are members of CREA. Used under license.