

# \$299,000 - 533 & 535 First Avenue, Beaver Mines

MLS® #A2237825

**\$299,000**

2 Bedroom, 1.00 Bathroom, 684 sqft

Residential on 0.28 Acres

NONE, Beaver Mines, Alberta

If you have been looking for somewhere to relax with gorgeous views and outdoor adventure at your doorstep, you won't want to miss this one! The cute two bedroom cabin sits on a 12,000 square foot piece of land in picturesque Beaver Mines, and it could be yours. Just minutes from lake or river fishing, skiing, biking, hiking, kayaking, snowshoeing, or golfing - the list is endless. Call your favourite REALTOR® to see it today.

## Essential Information

MLS® #	A2237825
Price	\$299,000
Bedrooms	2
Bathrooms	1.00
Full Baths	1
Square Footage	684
Acres	0.28
Type	Residential
Sub-Type	Detached
Style	Cottage/Cabin
Status	Active

## Community Information

Address	533 & 535 First Avenue
Subdivision	NONE
City	Beaver Mines
County	Pincher Creek No. 9, M.D. of

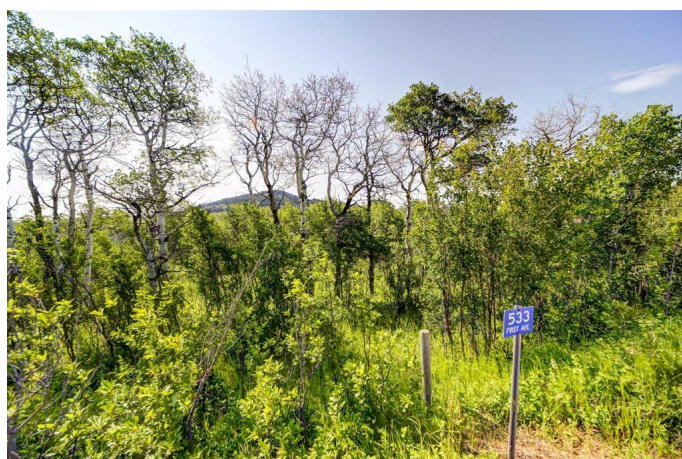

Province	Alberta
Postal Code	T0K1W0

### Amenities

Parking	None
---------	------

### Interior

Interior Features	See Remarks
Appliances	Microwave, Refrigerator, Stove(s), Washer/Dryer
Heating	Forced Air
Cooling	None
Basement	None

### Exterior

Exterior Features	None
Lot Description	Back Yard, Backs on to Park/Green Space, Many Trees, No Neighbours Behind, Views
Roof	Asphalt Shingle
Construction	Wood Siding
Foundation	Block

### Additional Information

Date Listed	July 8th, 2025
Days on Market	2
Zoning	Hamlet Residential

### Listing Details

Listing Office	Grassroots Realty Group
----------------	-------------------------

Data is supplied by Pillar 9â„¢ MLS® System. Pillar 9â„¢ is the owner of the copyright in its MLS® System. Data is deemed reliable but is not guaranteed accurate by Pillar 9â„¢. The trademarks MLS®, Multiple Listing Service® and the associated logos are owned by The Canadian Real Estate Association (CREA) and identify the quality of services provided by real estate professionals who are members of CREA. Used under license.