

\$79,000 - 10 Susquehanna Avenue, Rural Cardston County

MLS® #A2240206

\$79,000

0 Bedroom, 0.00 Bathroom,
Land on 3.24 Acres

NONE, Rural Cardston County, Alberta

Quiet Comfort in the Heart of Nature. If you're looking for a place where peace, privacy, and mountain beauty meet, this lot may be just what youâ€™ve been searching for. Sitting on just under 3.2 acres, this rectangular parcel offers plenty of space to build a home that fits your lifestyle â€“ whether thatâ€™s a modern farmhouse, a cozy retreat, or a thoughtfully designed Airbnb getaway. Located just outside of Cardston, youâ€™ll have quick access to town while enjoying the solitude and stillness of the countryside. Power and gas are both nearby, and water access can be arranged through hauling or the installation of a well. The land is flat and open, perfect for building, and the views stretch endlessly in every direction. With adventure close by at Waterton National Park and relaxation waiting at the beach on St. Maryâ€™s Reservoir, this is a rare opportunity to craft the life you want â€“ right from the ground up. Don't miss out! Call your favourite REALTOR® today!

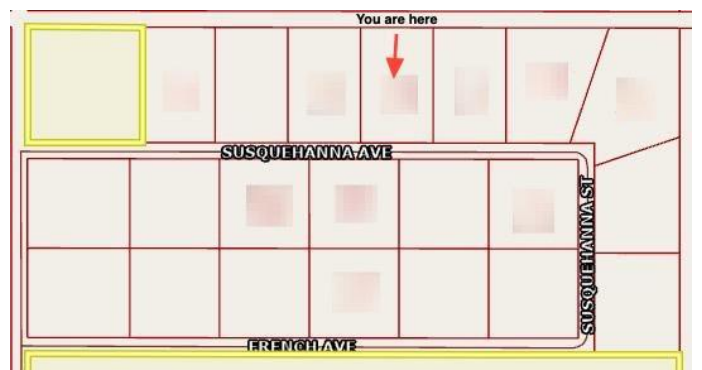
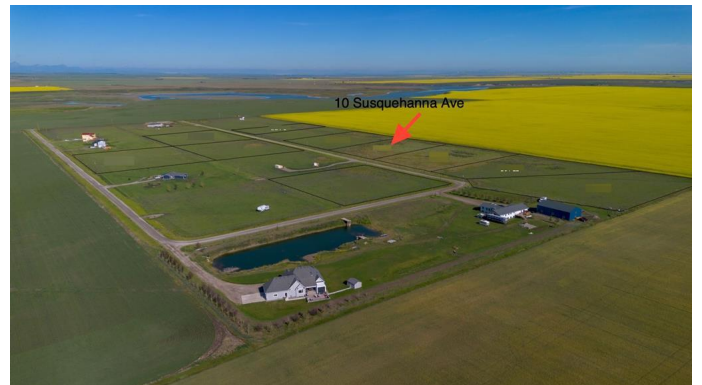

Essential Information

MLS® #	A2240206
Price	\$79,000
Bathrooms	0.00
Acres	3.24
Type	Land

Sub-Type	Residential Land
Status	Active

Community Information

Address	10 Susquehanna Avenue
Subdivision	NONE
City	Rural Cardston County
County	Cardston County
Province	Alberta
Postal Code	T0K 0K0

Additional Information

Date Listed	July 14th, 2025
Days on Market	1
Zoning	GCR

Listing Details

Listing Office	Grassroots Realty Group
----------------	-------------------------

Data is supplied by Pillar 9â„¢ MLS® System. Pillar 9â„¢ is the owner of the copyright in its MLS® System. Data is deemed reliable but is not guaranteed accurate by Pillar 9â„¢. The trademarks MLS®, Multiple Listing Service® and the associated logos are owned by The Canadian Real Estate Association (CREA) and identify the quality of services provided by real estate professionals who are members of CREA. Used under license.